



sealing solutions

UTEC molding **Wiper Seal W02**

UTEC Wiper Seal W02 is single-acting hydraulic, wiper seal, extrusion outside diameter installation. Wiper edge assures a reliable protection against penetration of dust and dirt.



TECHNICAL DATA	
Working Temperature	-30 +100°
Sliding Speed	1.00m/s
Material	92PU
Surface Roughness	
Ra	Rmax
Dynamic Surface	≤0.4 μm ≤3.2 μm
Groove Base	≤1.6 μm ≤10 μm
Groove Flanks	≤3.2 μm ≤16 μm

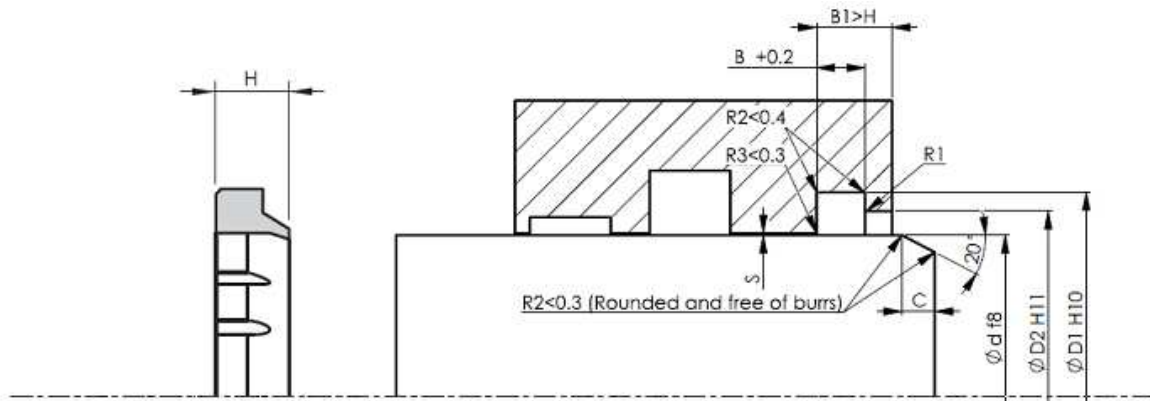

UTEC Sealing Solutions Co., Ltd.

Address: No.25 JiangTianli Rd,south JiePu Rd,SIP,Suzhou , P.R. China

Tel:+86 (512) 62795018*16 Fax: +86 (512) 62797880

Whatsapp:+86 18896801765

Skype:utecsealing

CN EN KR RU

E-mail:wang.anlei@utec.cc

DE EN ES FR PT

Email:tom.pohl@utec.cc